

M5 Sensor and Actuator

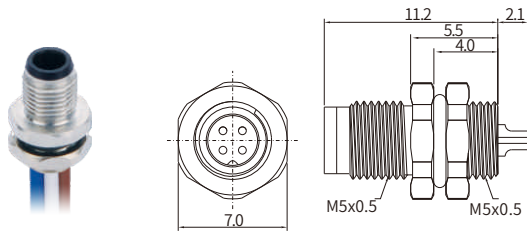

M5 Straight Connector, Panel Mount, Solder, Rear fastened

Male



Female

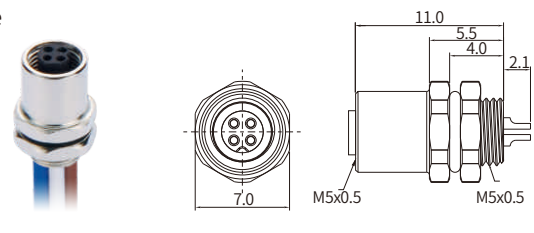

Specifications

Contacts	3	4
Pin layout(Male)		
Pin layout(Female)		
Standard	IEC 61076-2-105	
Ambient temperature	-15°C~+85°C (flexible installation), -30°C~+85°C (fixed installation)	
Customized temperature	-25°C ~ +85°C (flexible installation), -40°C ~ +85°C (fixed installation)	
Connector insert	TPU; PA+GF	
Connector contacts	Brass with gold plated	
Coupling nut/screw	Brass with nickel plated	
Seal/O-ring	Epoxy resin / FKM	
Insulation resistance	≥100MΩ	
Contact resistance	≤5mΩ	
Earth tag/pin	Unavailable	
IP rating	IP67 in locked condition	
Mating endurance	>500 cycles	
Rated current	1 A	
Rated voltage	60V AC/DC	
Wire gauge	0.14mm ² (AWG26)	

Part Number

Pins	Cable length	Male	Female
3	0.1m	MB05MSARF03ST-1401	MB05FSARF03ST-1401
	0.3m	MB05MSARF03ST-1403	MB05FSARF03ST-1403
4	0.1m	MB05MSARF04ST-1401	MB05FSARF04ST-1401
	0.3m	MB05MSARF04ST-1403	MB05FSARF04ST-1403

Default wire colors

Pin No.		
Pin 1	BN	BN
Pin 2		WH
Pin 3	BU	BU
Pin 4	BK	BK

Panel Cut-out Dimensions

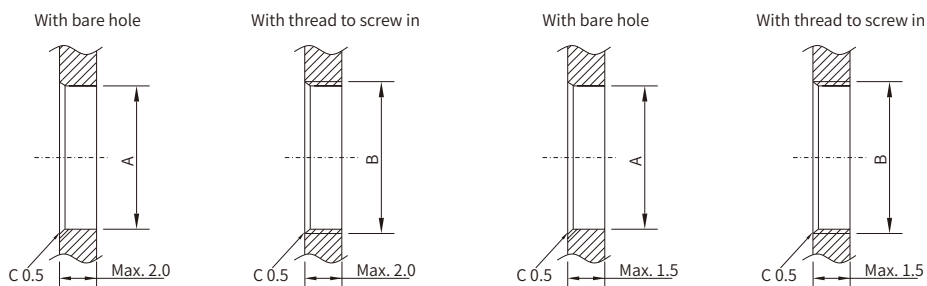

	A	B
M5	5.0 ^{+0.1} ₋₀	M5x0.5
M7	5.0 ^{+0.1} ₋₀	M5x0.75